

PREPARED BY:  
AERIAL SURVEY AND PHOTO, INC.  
546 AIRPORT ROAD PO BOX 659  
NORRIDGEWICK, MAINE 04957  
TEL: 207 634-2006 FAX 207 634-2008

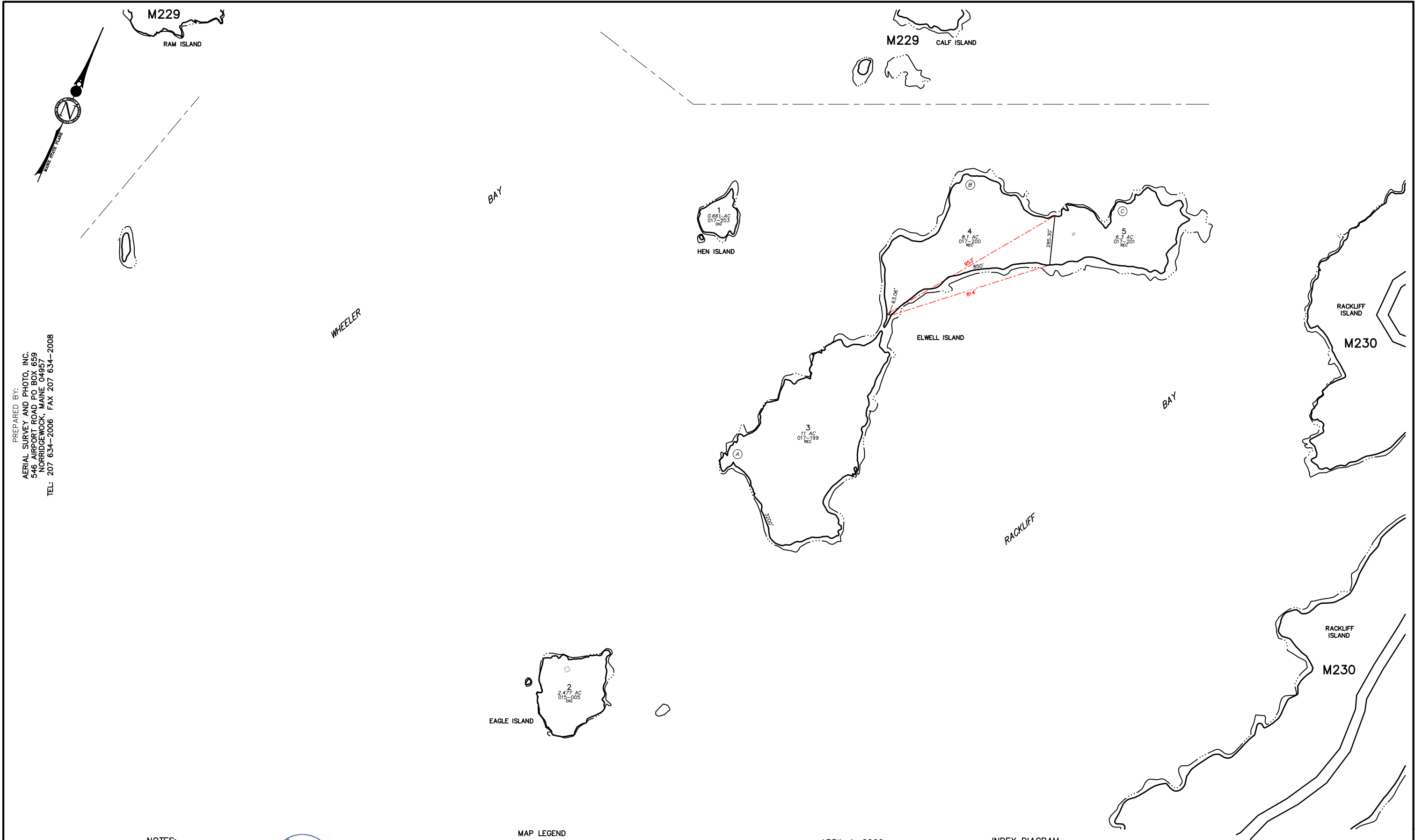

NOTES:

- 1) THIS MAP IS FOR ASSESSMENT PURPOSES ONLY AND IS NOT INTENDED FOR PROPERTY CONVEYANCE OR LEGAL DESCRIPTION.
- 2) REC = PARCEL ACREAGE FROM RECORDED PLAN OR DEED  
DIG = PARCEL ACREAGE CALCULATED DIGITALLY



TOWN OF SAINT GEORGE  
3 SCHOOL ST., PO BOX 131  
TENANTS HARBOR, ME 04860

PARCEL NUMBER .....	23
PARCEL DIMENSION .....	161.21'
PARCEL AREA .....	2.456 AC
MATCH LABEL .....	P/O MAP 136 LOT 23
BUILDING FOOTPRINT .....	
RECORDED PLAN LOT NUMBER .....	23
OLD MAP-LOT NUMBER .....	013-007-00C
TIE LINE DIMENSION .....	147'

MAP LEGEND

PARCEL BOUNDARY .....	
WATER LINE .....	
ROAD RIGHT OF WAY .....	
PAPER STREET .....	
EASEMENT LINE .....	
PRIVATE RIGHT OF WAY .....	
WETLAND EDGE .....	
TIE LINE .....	

APRIL 1, 2022

SCALE 1 INCH = 200 FEET

MAINE STATE PLANE COORDINATE GRID: EAST ZONE; NAD 1983; US FEET  
PHOTOGRAPHY DATE: APRIL 20, 2004  
PHOTOGRAMMETRIC COMPILATION BY AERIAL SURVEY AND PHOTO, INC.  
PARCEL MAP COMPILATION BY AERIAL SURVEY AND PHOTO, INC.

INDEX DIAGRAM

106	229	234
223	226	230

PROPERTY MAP  
TOWN OF ST. GEORGE  
KNOX COUNTY, MAINE

226